

## Technical specification sheet

# HAC 100 H 10 | Aluminium Cylinder

Specifications		
article number		100.122.109
short description		Aluminium Cylinder
model		HAC 100 H 10
max. working pressure	bar/Mpa	720 / 72
tonnage	t	100
stroke	mm	100
closed height	mm	296
capacity	kN/t	1030.6 / 105.1
effective pressure area (press)	cm <sup>2</sup>	143.1
effective pressure area (retract)	cm <sup>2</sup>	56.5
required oil content (effective)	cc	865
required oil content (press)	cc	1431
required oil content (retract)	cc	565
connection		A 118
cylinder type		standard
acting type		double
return type		hydraulic
material		aluminium
weight, ready for use	kg	23.0
ASME		B30.1

Technical drawing dimensions		
dimension A	mm	296
dimension B	mm	195
dimension C	mm	105
dimension D1	mm	76
dimension D2	mm	76
dimension E	mm	35
dimension F	mm	285
dimension P	mm	72
I type		[I2]

### Standard supplied with

- High flow female coupler A118
- Flat saddle
- Larger cylinders are equipped with handles for easy carrying and positioning

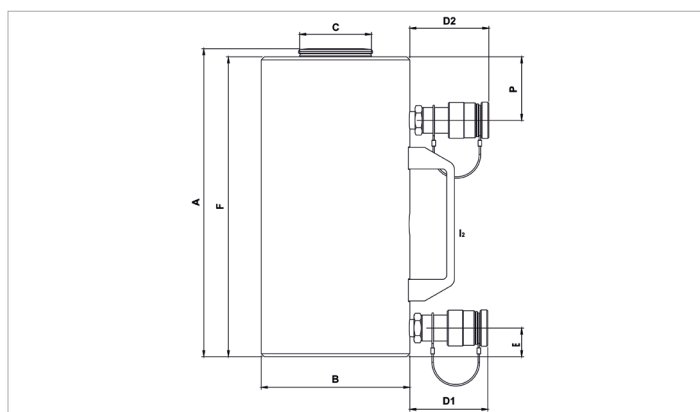

[holmatro.com](http://holmatro.com)

© Holmatro 2023-11-30

While the greatest care has been devoted to the content, it is possible that the information in this printed matter is incorrect or incomplete. Holmatro B.V. and its affiliated companies (hereafter: Holmatro) cannot be held liable in any way for the consequences of activities undertaken on the basis of this printed matter. Values can vary within the manufacturer measurements. If you have any doubts about the correctness or completeness of the information, you shall contact Holmatro (T +31 (0)162-751480). Nothing from this printed matter can be copied and/or made public in any way without the explicit authorisation of Holmatro.