

## Technical specification sheet

# FLS 85 M | Flange Spreader

Specifications			
article number			100.012.011
model			FLS 85 M
max. working pressure	psi		10443
short description			Flange Spreader
spreading force 30° wedge	lbf		16523
spreading force 60° wedge	lbf		7711
flange opening 30° wedge (min.)	in		0.1
flange opening 30° wedge (max.)	in		1
flange opening 60° wedge (min.)	in		0.1
flange opening 60° wedge (max.)	in		1.3
required oil content (effective)	oz		1.8
return type			spring
connection			A 118
weight, ready for use	lb		9.9
weight, incl. case	lb		13.9

Technical drawing dimensions			
dimension A	in		3.3
dimension B	in		0.6
dimension C	in		1.2
dimension D	in		5.1
dimension E	in		10.4

Standard supplied with	
• High Flow female coupler A 118	
• 60° Spreading wedge	
• Plastic carrying box, including high-grade grease Molycote®	

Accessories	
Wedge FLS 85 NU, 30 Degree Angle	100.103.009

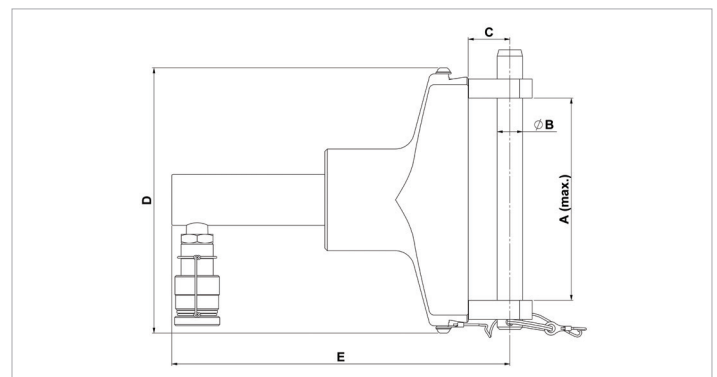

[holmatro.com](http://holmatro.com)

© Holmatro 2020-10-03

While the greatest care has been devoted to the content, it is possible that the information in this printed matter is incorrect or incomplete. Holmatro B.V. and its affiliated companies (hereafter: Holmatro) cannot be held liable in any way for the consequences of activities undertaken on the basis of this printed matter. Values can vary within the manufacturer measurements. If you have any doubts about the correctness or completeness of the information, you shall contact Holmatro (T +31 (0)162-751480). Nothing from this printed matter can be copied and/or made public in any way without the explicit authorisation of Holmatro.